



Young Harris Terraces, c. 1875
NORTH CAMPUS PRECINCT
Average Dimensions: 260'x200'
Area: 68,275 sf



Franklin Quad (north quad), 19th century
NORTH CAMPUS PRECINCT
Average Dimensions: 650'x220'
Area: 173,475 sf



South Quad, 20th century
NORTH CAMPUS PRECINCT
Average Dimensions: 500'x215'
Area: 122,800 sf

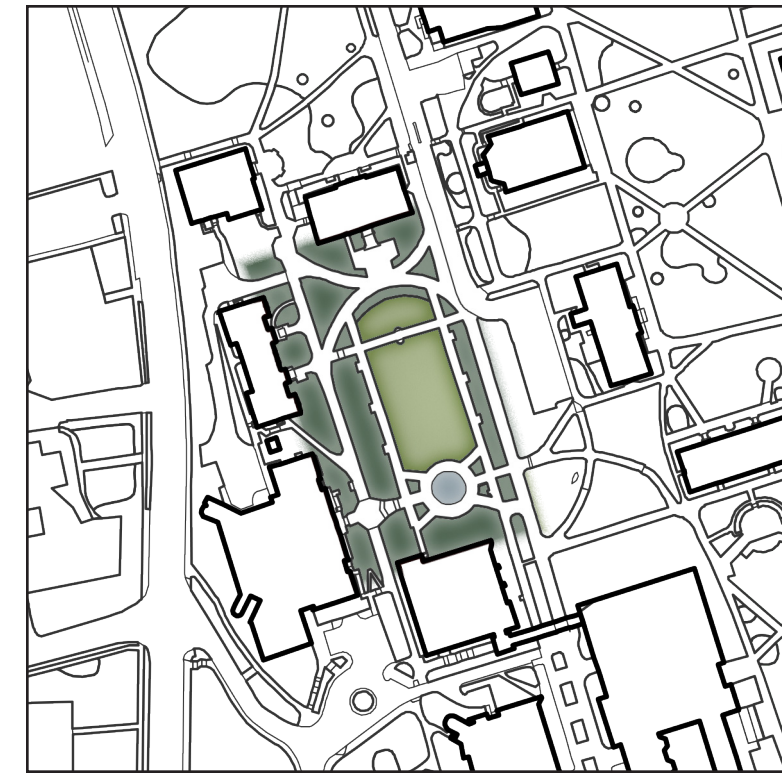

Herty Field, c. 1999
NORTH CAMPUS PRECINCT
Average Dimensions: 350'x150'
Area: 61,675 sf

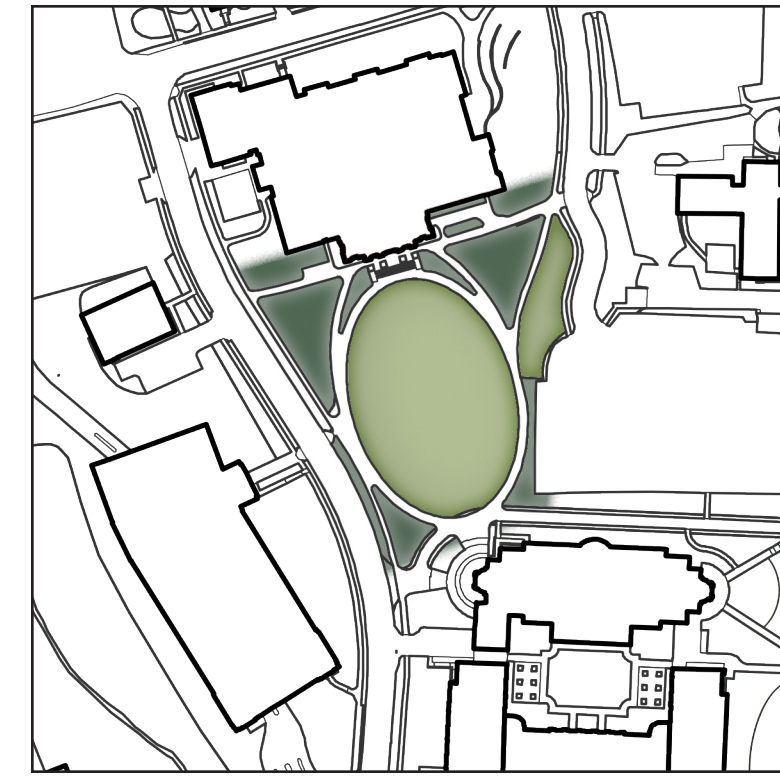

Special Collections Libraries oval green, c. 2011
NORTHWEST CAMPUS PRECINCT
Average Dimensions: 290'x250'
Area: 77,200 sf

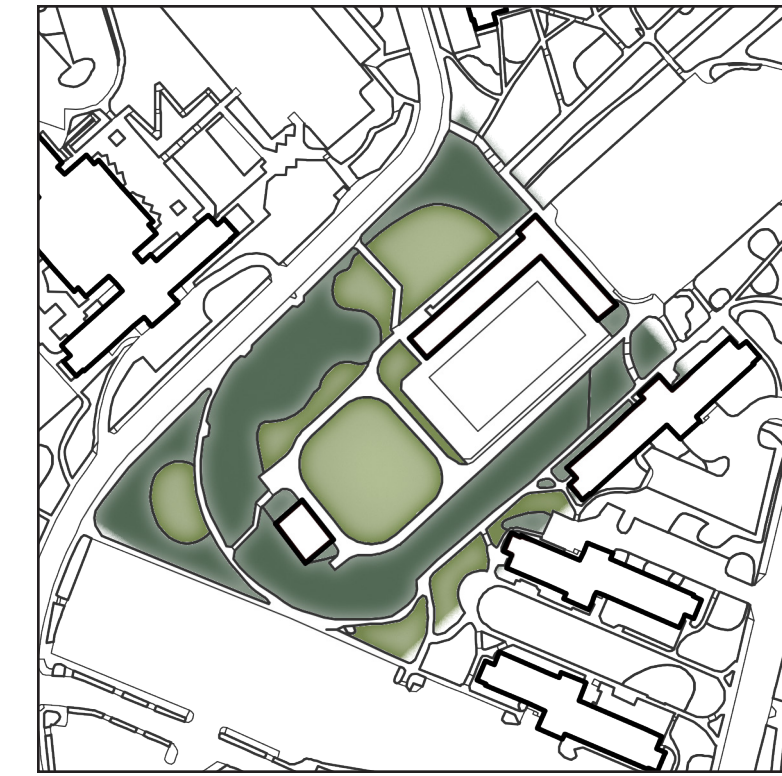

Legion Field, c. 1930's
CENTRAL CAMPUS PRECINCT
Average Dimensions: 260'x300'
Area: 76,075 sf



Georgia Quad, c. 2003-2006
CENTRAL CAMPUS PRECINCT
Average Dimensions: 450'x150'
Area: 71,225 sf



D.W. Brooks Memorial, c. 2006
SOUTH CAMPUS PRECINCT
Average Dimensions: 250'x195'
Area: 46,550 sf

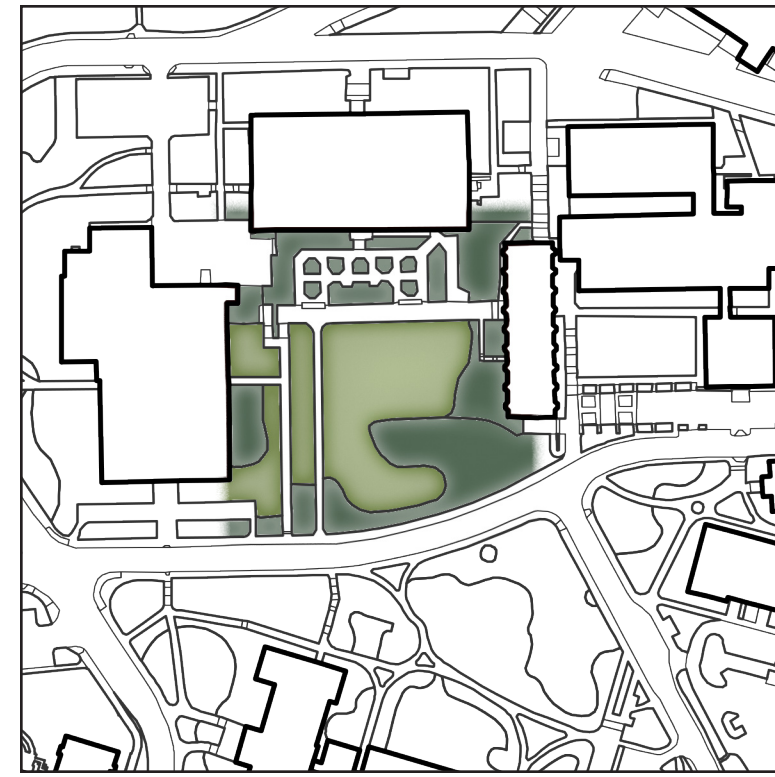

Geography-Geology Quad, c. 1959
SOUTH CAMPUS PRECINCT
Average Dimensions: 250'x285'
Area: 80,000 sf

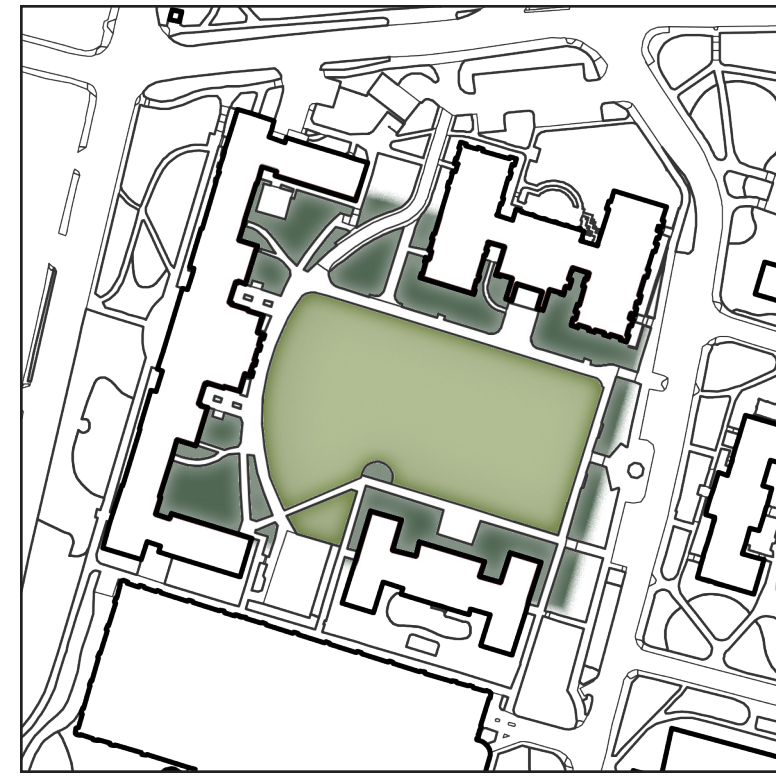

Myers Quad, early 20th century
SOUTH CAMPUS PRECINCT
Average Dimensions: 250'x400' sf
Area: 106,100 sf



Performing & Visual Arts corridor, c. 2011
EAST CAMPUS PRECINCT
Average Dimensions: 285'x150'
Area: 41,400 sf



East Campus Village green, c. 2004
EAST CAMPUS PRECINCT
Average Dimensions: 470'x160'
Area: 78,750 sf

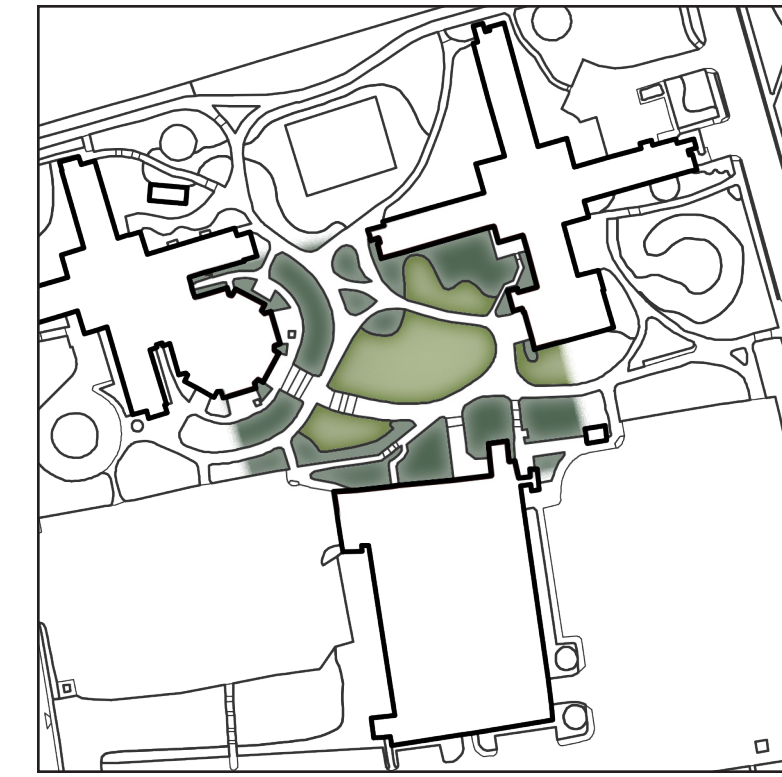

Brumby-Russell green, c. 1966-1967
CENTRAL CAMPUS PRECINCT
Average Dimensions: 245'x200'
Area: 42,200 sf

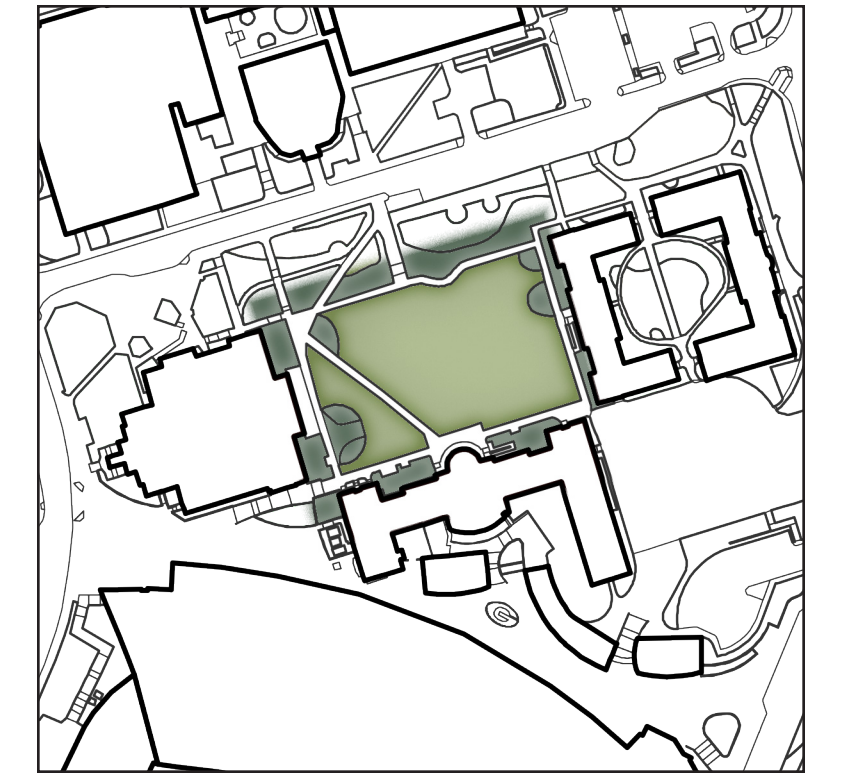

Memorial Hall-Reed Hall Quad, c. 1921
CENTRAL CAMPUS PRECINCT
Average Dimensions: 310'x210'
Area: 63,225 sf



D.W. Brooks Pedestrian Mall, c. 2001-2006
SOUTH CAMPUS PRECINCT
Average Dimensions: 960'x160'
Area: 155,775 sf



Office of University Architects for Facilities Planning
UNIVERSITY OF GEORGIA

[ICONIC CAMPUS QUADS & COURTYARDS]

The University of Georgia's Physical Master Plan is grounded in guiding principles that hold campus green spaces in the highest esteem. Among them, *Extend the characteristics of North Campus, Develop a connected campus, Provide the optimal student environment, and Enhance Natural Resources* are complementary planning aims that intersect across the university's historic and contemporary landscapes. As the Office of University Architects **plans, designs, builds, and preserves** the University of Georgia, the scale and proportion of these iconic quads and courtyards are as instructive as the material and form of their adjacent architecture in guiding our work. Though not an exhaustive inventory of UGA's many memorable outdoor places, examples here from across Athens main campus are highlighted at 1"=200' (when printed full-size at 24"x36") with estimated dimensions and area to inform future work by reference. Light green areas are characterized primarily by sod ground cover while dark green areas are maintained with a mix of shrubs and/or trees.



Founders Memorial Garden (lawn), c. 1941
NORTH CAMPUS PRECINCT
Average Dimensions: 100'x 60'
Area: 5,640 sf

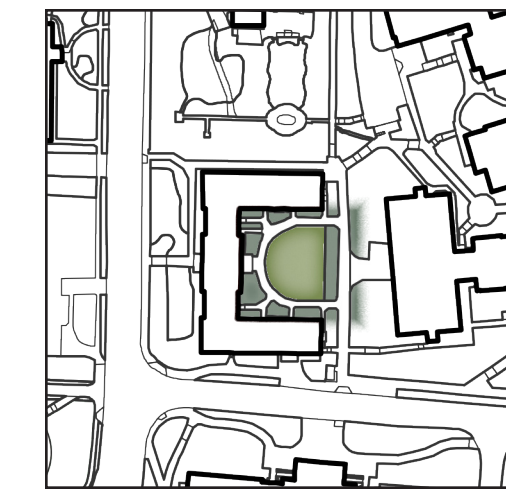

Joe Brown Hall courtyard, c. 1932
NORTH CAMPUS PRECINCT
Average Dimensions: 115'x100'
Area: 12,000 sf

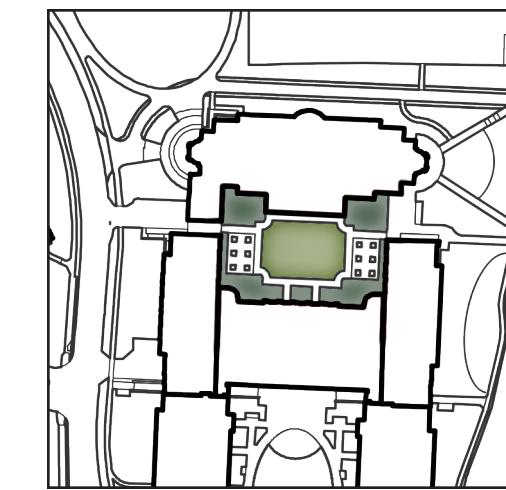

Foley Courtyard, c. 2017
NORTHWEST CAMPUS PRECINCT
Average Dimensions: 170'x95'
Area: 16,075 sf



Davis Courtyard, c. 2015
NORTHWEST CAMPUS PRECINCT
Average Dimensions: 100'x125'
Area: 13,050 sf

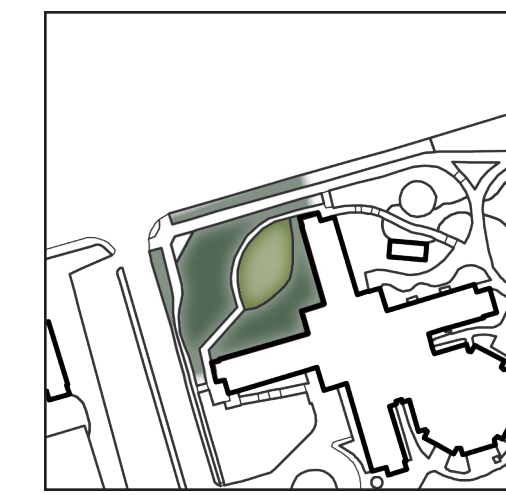

Brumby Beach, c. 1966
CENTRAL CAMPUS PRECINCT
Average Dimensions: 100'x100'
Area: 10,575 sf

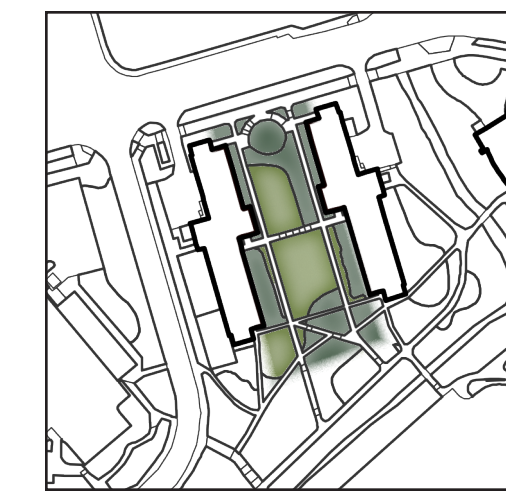

Mell-Libscob green, c. 1961
CENTRAL CAMPUS PRECINCT
Average Dimensions: 250'x100'
Area: 25,425 sf



Boggs-Church green, c. 1961
CENTRAL CAMPUS PRECINCT
Average Dimensions: 300'x100'
Area: 28,200 sf

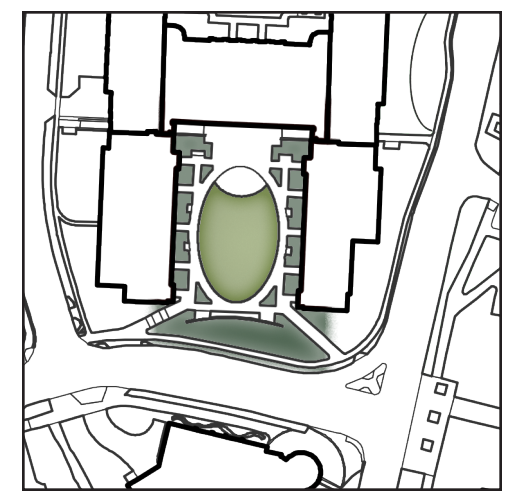

Coca-Cola Plaza, c. 2019
NORTHWEST CAMPUS PRECINCT
Average Dimensions: 200'x135'
Area: 25,460 sf



McPail Center green, c. 1940
SOUTH CAMPUS PRECINCT
Average Dimensions: 200'x85'
Area: 16,285 sf

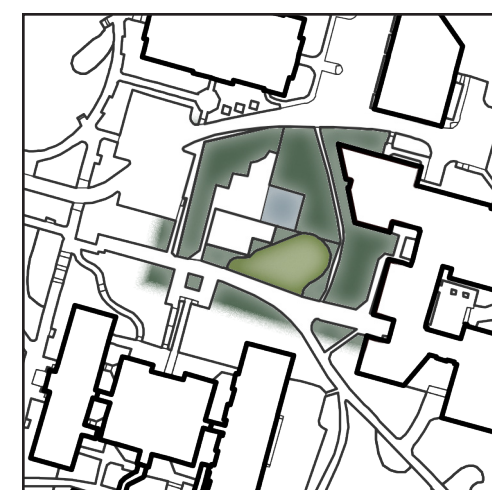

Mary Kahrs Garden, c. 1989
SOUTH CAMPUS PRECINCT
Average Dimensions: 150'x160'
Area: 19,800 sf

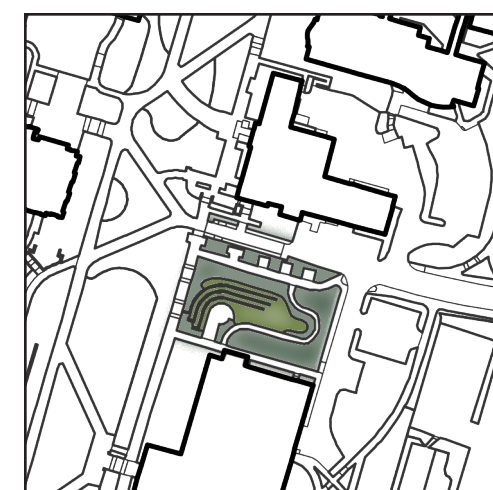

Jaworski Amphitheatre, c. 2006
SOUTH CAMPUS PRECINCT
Average Dimensions: 150'x100'
Area: 13,975 sf

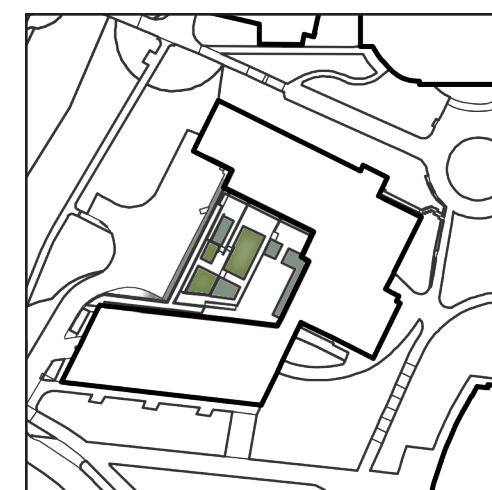

Georgia Museum of Art Courtyard, c. 2011
EAST CAMPUS PRECINCT
Average Dimensions: 120'x120'
Area: 13,620 sf

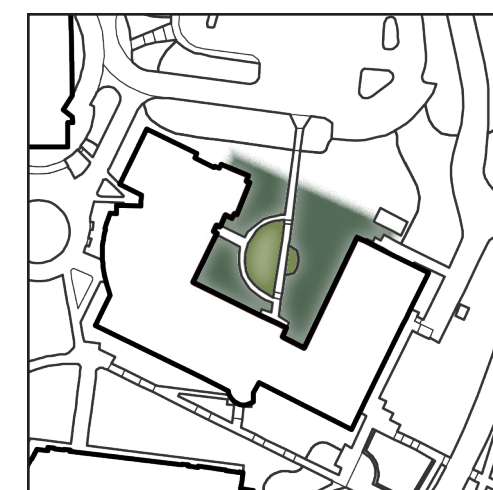

Hugh Hodgson Sch of Music Quad, c. 1995
EAST CAMPUS PRECINCT
Average Dimensions: 120'x125'
Area: 18,235 sf

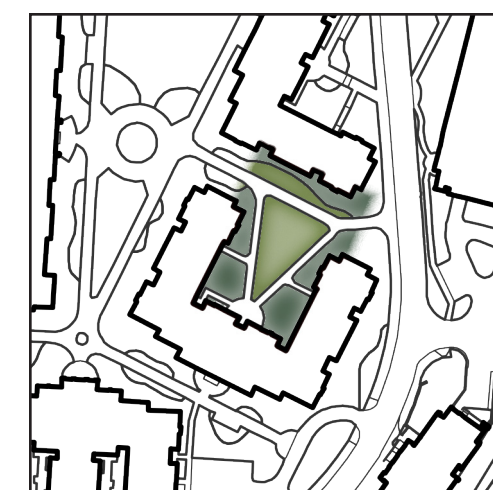

Vandiver Hall courtyard, c. 2004
EAST CAMPUS PRECINCT
Average Dimensions: 140'x105'
Area: 14,120 sf

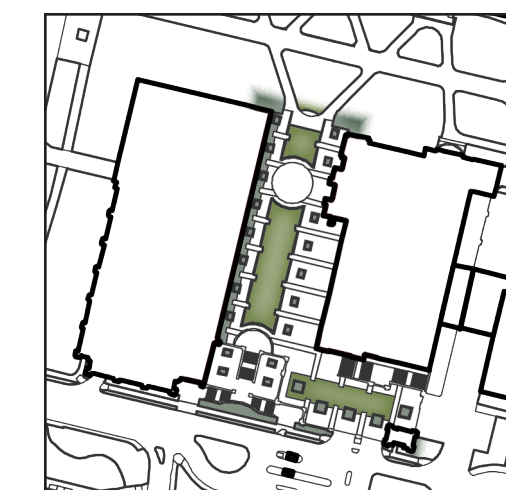

Alumni Quad, c. 2006
EAST CAMPUS PRECINCT
Average Dimensions: 245'x90' (west lawn)
Area: 32,045 sf

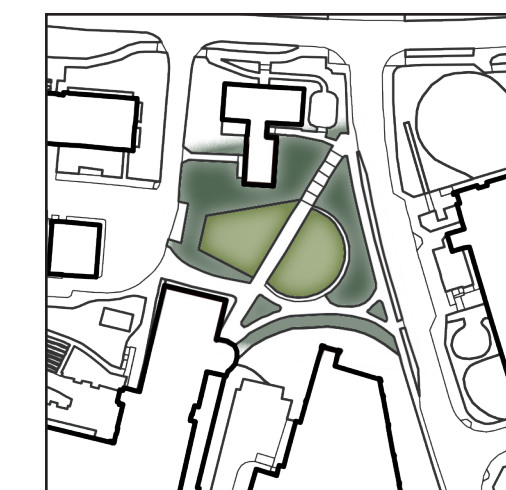

Memorial Garden, c. 2003
CENTRAL CAMPUS PRECINCT
Average Dimensions: 175'x110'
Area: 18,750 sf

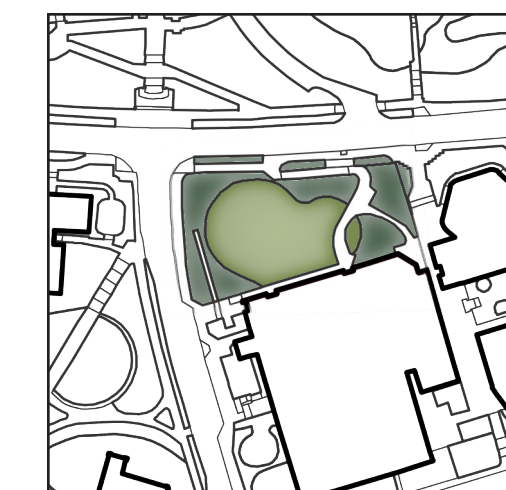

Journalism (north garden), c. 2012-2013
CENTRAL CAMPUS PRECINCT
Average Dimensions: 200'x125'
Area: 22,650 sf

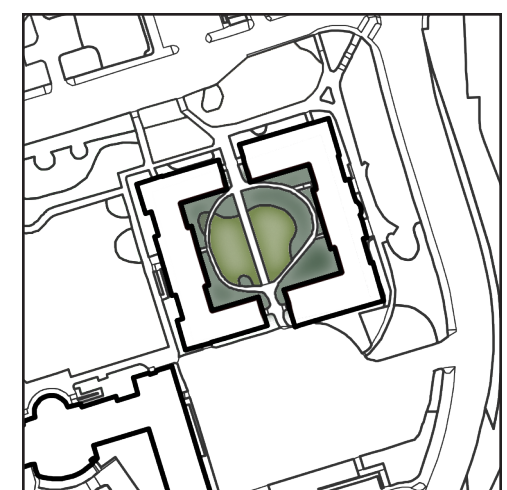

Milledge-Payne courtyard, c. 1939
CENTRAL CAMPUS PRECINCT
Average Dimensions: 135'x115'
Area: 15,550 sf